

REV.	DESCRIPTION	DATE
A	RELEASE	Nov 30, 2014

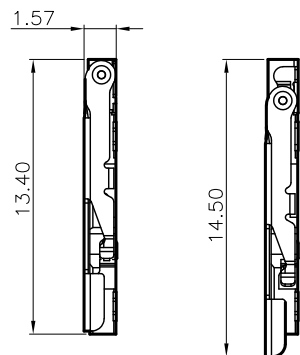

SLIDE SHELL OPEN SLIDE SHELL LOCK

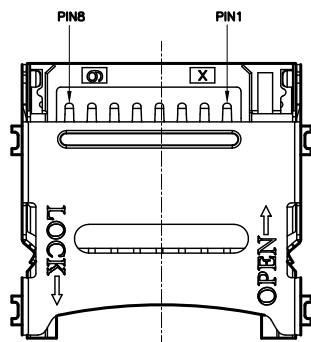
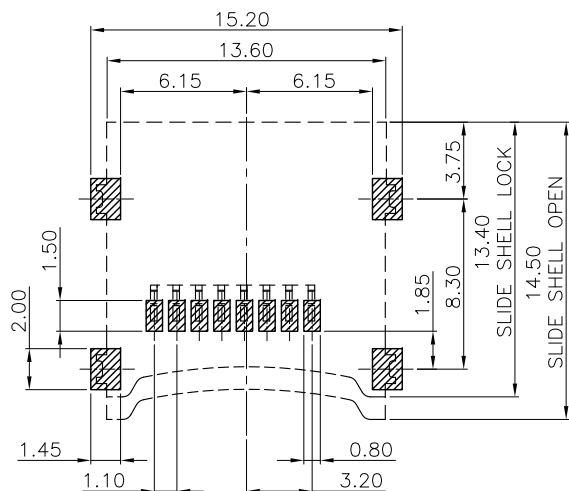
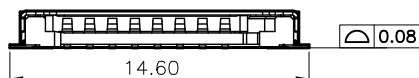
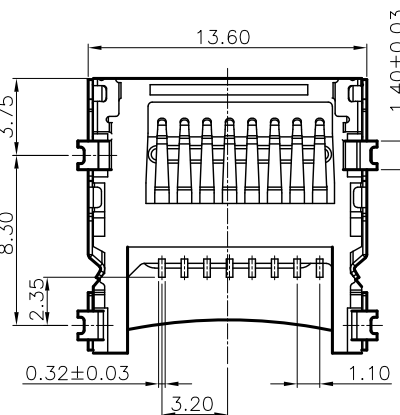

RECOMMEND PCB LAYOUT
TOLERANCE: ±0.05
TOP VIEW

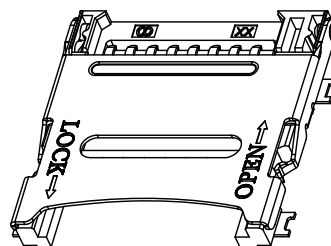

MATERIALS

- HOUSING : THERMOPLASTIC ,UL94 V-0.
- TERMINAL : COPPER ALLOY, PLATING SEE TABLE.
PLATING: GOLD PLATED ON CONTACT AREA,
G/F GOLD PLATED ON SOLDER TAILS.
- SHELL : SUS.
- SOLDER : COPPER ALLOY .
PLATING :80u"~120u" TIN PLATED ON SOLDER TAILS,
50U"~80U" NICKEL PLATED OVERALL.

SPECIFICATION

- CURRENT RATING : 0.5 A. MAX.
- VOLTAGE RATING:5V.
- DIELECTRIC WITHSTANDING VOLTAGE :
500V AC R.M.S. FOR 1 MINUTE.
- INSULATION RESISTANCE : 100MQ MIN.AT 5V DC.
- CONTACT RESISTANCE : 50mΩ MAX.
- OPERATING TEMPERATURE : -30°C TO +85°C.
- DURABILITY:5000 CYCLES.

PART NUMBER INFORMATION :

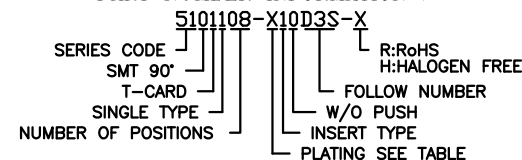

DESCRIPTION OF PLATING ON TERMINALS

NO.	EXPLAIN	NO.	EXPLAIN
0	GOLD FLASH	3	GOLD 15u"
1	GOLD 5u"	4	GOLD 20u"
2	GOLD 10u"	H	G/F + TIN

PIN1	DAT2
PIN2	CD/DAT3
PIN3	CMD
PIN4	VDD
PIN5	CLK
PIN6	VSS
PIN7	DAT0
PIN8	DAT1
PIN NO.	

TOLERANCE	DRAWER <i>SORLICHY</i> CHECK <i>SORLICHY</i> APP'D <i>SORLICHY</i> PRODUCT SPEC.
.0=±0.25 .00=±0.15 .000=±0.05 ANG.=±3°	
	SCALE NONE SIZE A7 SHEET 1 OF 1 REV. A
UNITS : mm	

INMO	
东莞市英墨电子有限公司 INMO Electronics Co.,Ltd	
NAME	T-FLASH SOCKET 掀盖式/无柱(1.6H)
DRAW NO.	R5101108-X10D3S-X